

# Deluxe Touch-Free Hand Sanitizer

## Product Parts

1. Post with cap
2. Backer Plate
3. Base
4. Snap Frame
5. Touch-Free Hand Sanitizer
6. M6x1.0 Screw (x2)
7. M5x0.8 Screw (x3)
8. Key
9. #3 & #4 Hex Wrench



## Display Set-Up

### Step 1

If you have ordered a graphic only, affix \*graphic to base first then attach the Post (1) to the Base (3) with the two M6x1.0 Screws (6), using the #4 Hex Wrench (9). \*Base Graphic will be installed for you if you have ordered a kit.

### Step 2

Insert two M5x0.8 Screws (7) through holes on Backer Plate (2) and secure to Post (1).

### Step 3

Align notch on back of Snap Frame (4) to screw already inserted near top of Post (1) and push downward to lock in place.

### Step 4

Open the bottom rail of the Snap Frame (4) to gain access to the single hole and place one M5x0.8 Screw (7) through hole into Post (1) to secure Snap Frame (4) in place.

### Step 5

Attach Touch-Free Hand Sanitizer (5) by aligning notches on back to the pins on Backer Plate (2) and push downward to lock in place.

## NOTE:

Fill with your favorite hand sanitizer. **(NOT INCLUDED)**

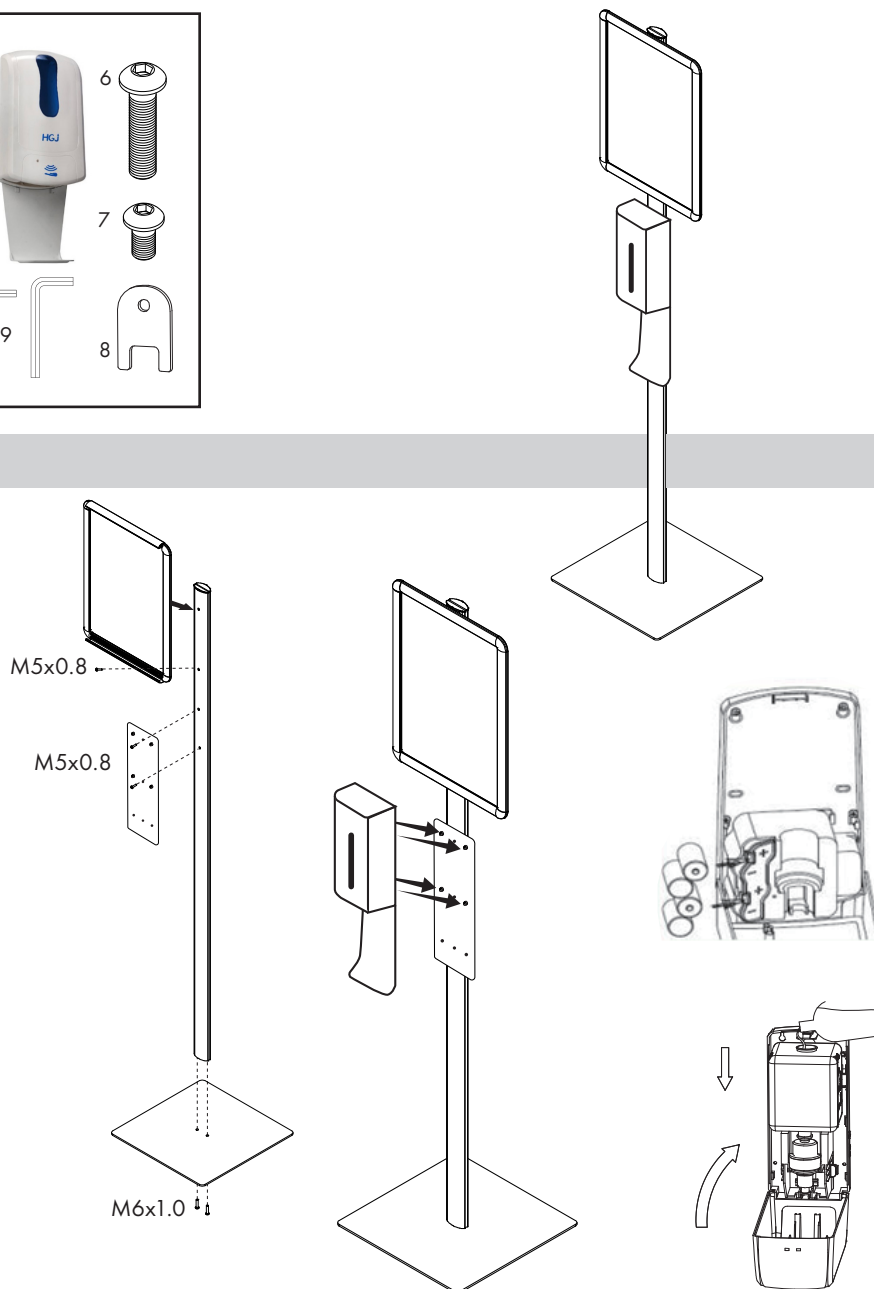

## Graphic Install for Frame

Open the snap edges and remove the protective film and place it over your \*graphic. Place graphic with the protective film on top, into the Snap Frame (4). Close the snap edges. \*Frame Graphic will be installed for you if you have ordered a kit.



## Storage & Care

To Store: Store upright in a cool dry place. To Clean: Use soap and water.

DO NOT USE homemade formulas of sanitizer. For further guidance on sanitizer solutions go to <https://www.fda.gov/media/136289/download> the FDA's guidance on sanitizer products.